

PRINT ISSUE							
DATE	NO.	TO	FOR	DATE	NO.	TO	FOR
SHIP PAINT: NONE				DWG. OF PICTORIAL VIEW LOOKING NORTHWEST			
SURFACE PREP: SSPC-SP3				JOB NAME SOUTH LAKE HOSPITAL EXPANSION			
HOLES: 1 3/16 DIA. UNLESS NOTED				LOCATION CLERMONT, FLORIDA			
BOLTS: AS NOTED				CUSTOMER THE ROBINS AND MORTON GROUP			
FIELD CONNECTIONS: 3/4 DIA. A325N UN				ARCHT. OR ENG. FRED M. HUMPHREY & ASSOCIATES, INC.			
REVISIONS							
NO.	DATE	BY	DESCRIPTION				
DRAWN BY: BV Detailing				CHECKED BY: DG			
JOB NO: 4-150							
DWG. NO: Iso1							

FabArc Steel Supply, Inc.  
 111 MEADOW LANE  
 OXFORD, AL 36202  
 (256) 831-8770

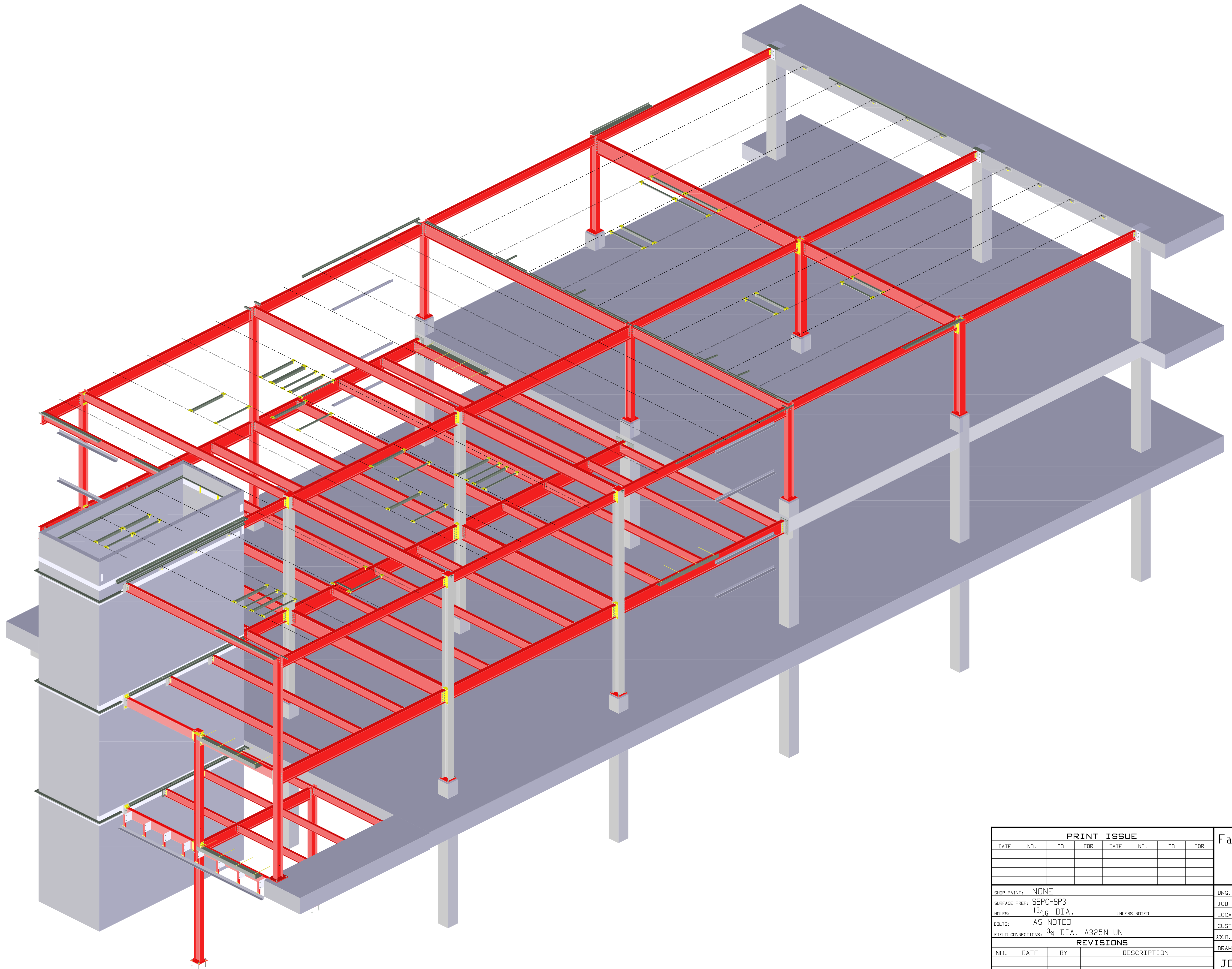

PRINT ISSUE							
DATE	NO.	TO	FOR	DATE	NO.	TO	FOR

FabArc Steel Supply, Inc.  
 111 MEADOW LANE  
 OXFORD, AL 36202  
 (256) 831-8770

SHOP PAINT: NONE  
 SURFACE PREP: SSPC-SP3  
 HOLES: 1 3/16 DIA. UNLESS NOTED  
 BOLTS: AS NOTED  
 FIELD CONNECTIONS: 3/4 DIA. A325N UN

DWG. OF PICTORIAL VIEW LOOKING SOUTHWEST  
 JOB NAME SOUTH LAKE HOSPITAL EXPANSION  
 LOCATION CLERMONT, FLORIDA  
 CUSTOMER THE ROBINS AND MORTON GROUP  
 ARCHT. OR ENG. FRED M. HUMPHREY & ASSOCIATES, INC.  
 DRAWN BY: BV Detailing CHECKED BY: DG

REVISIONS			
NO.	DATE	BY	DESCRIPTION

JOB NO: 4-150  
 DWG. NO: Iso2