

SHOP NOTE "A":
ROLLED MATERIAL IS BILLED ACTUAL
LENGTH ALONG OUTSIDE FACE.

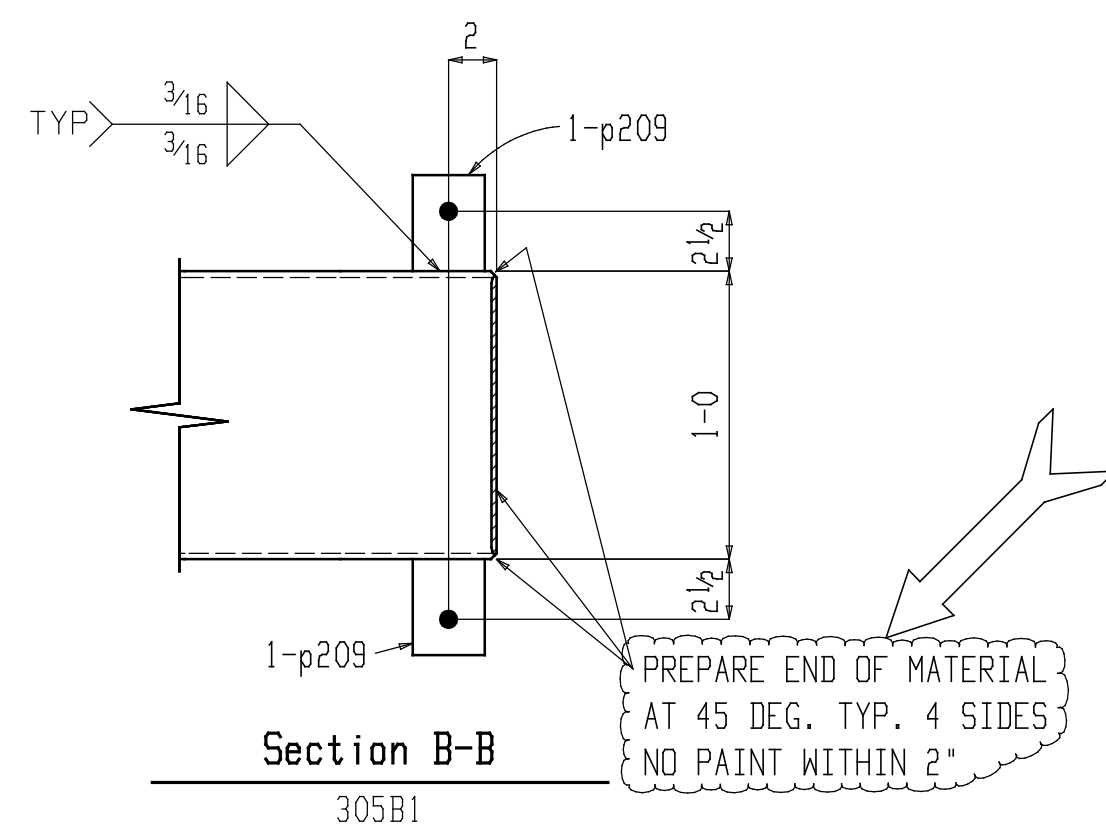
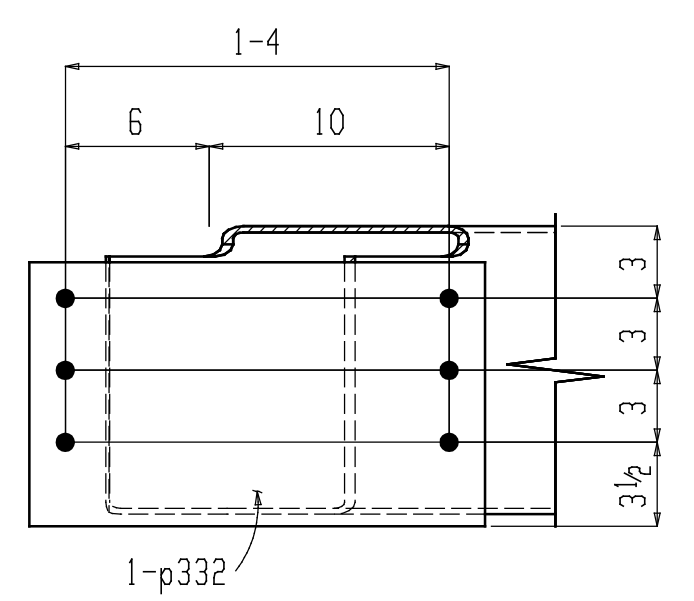

- SHOP NOTES:
1. ALL REENTRANT CUTS TO HAVE 1/2" RADIUS TYP.
 2. SEE BILL OF MATERIAL FOR MATERIAL GRADE.
 3. WELD E70 SERIES LOW HYDROGEN ELECTRODES.
 4. SYMBOL INDICATING FRAMING SIDE (SPOT w/PAINT): ☒
 5. EXTENSION INDICATING ORIGIN POINT INDICATED THUS: ●
 6. HOLES ARE 1 3/16" DIAMETER UNLESS NOTED OTHERWISE.

PAINT: 1 S/C STD. IRON OXIDE PRIMER 1.5 MIL MIN. UN

| LINE | MINDR MARK | QUAN UNIT | QUAN TOTAL | MATERIAL DESCRIPTION | MAT'L GRADE | LENGTH FT IN | PIECE MARK | REMARKS | WEIGHT TOTAL | ORDER ITEM |
|------|------------|-----------|------------|----------------------|-------------|--------------|------------|-------------------|--------------|------------|
| 1 | | | ONE | BEAM | | | 305B1 | | 664 | |
| 2 | 305B1 | 1 | 1 | HSS12x6x1/4 | A500B | 21 2 3/16 | | ROLLED SEE SN "A" | 620 | 15-5 |
| 3 | p209 | 2 | 2 | FL 3/8x4 | A36 | 0 3 | | | 3 | |
| 4 | p332 | 1 | 1 | PL 3/8x11 | A36 | 1 7 | | | 22 | |
| 5 | p337 | 2 | 2 | FL 3/8x5 | A36 | 1 0 | | | 13 | |
| 6 | p338 | 1 | 1 | FL 3/8x5 | A36 | 1 0 | | | 6 | |
| 7 | | | | | | | | | | |
| 8 | | | | | | | | | | |
| 9 | | | | | | | | | | |
| 10 | | | | | | | | | | |
| 11 | | | | | | | | | | |
| 12 | | | | | | | | | | |

| PRINT RECORD | | | | | |
|--------------|-------|-----------------------|------|-------|-----|
| Date | Quan. | For | Date | Quan. | For |
| 11-15-2004 | 6 | APPROVAL | | | |
| 12-09-2004 | | FABRICATION/FIELD USE | | | |

| Rev. | Date | Description | By |
|------|------|-------------|----|
| | | | |

IRWIN STEEL
15740 Highway 114 ~ Justin, Texas 76247
Phone (817) 636-2508 ~ Fax (817) 636-2506

Job Name: DALLAS EXECUTIVE AIRPORT
Location: DALLAS, TEXAS
Customer: MERIDIAN COMMERCIAL, L.P.
Architect: GRW WILLIS, INC.

DRAWN: BV DETAILING JOB NO: 0437 SHEET NO. 305
CHECKED: DG CAD NO: